

## LOK VASTU EVALUATION REPORT

### Client Details:

<Name>

<Company Name>

<Address>

**Visit Date:** <Date>

### Report By:

Dr. Pardieep Jain

Lok Vastu Shastra

Lok Vigyan Samridhi Pvt Ltd

**Lok Vigyan Samridhi Pvt Ltd**

E2-252 First Floor, Main Road, Shastri Nagar, Delhi-110052

CIN: U86900DL2024PTC428613 || PAN: AAFCL7702G

www.lokvastu.com || 91-9990888961 || drpardieepjain@lokvigyan.com

# **LOK VASTU REPORTS INDEX**

## **MAPS AND DRAWINGS**

1. Property Layout
2. Layout with Grid
3. 16 Direction Bar Chart
4. Mermaa Marking
5. 1 by 1 Graph
6. Zonals Dimensions
7. Element Chart
8. 45 Devtas Marking
9. 45 Devtas Barchart

## **PRESENT ANALYSIS**

1. Pre work Strength Analysis for 17 zones
2. Pre work Energy Analysis of 17 zones
3. Incorrect Placements Analysis
4. Incorrect Construction Report

## **REMEDIES AND SOLUTIONS**

1. Color Therapy Recommendations
2. Correct Placement Recommendation
3. Energy Balancing Recommendation

## **RESULTS**

1. Post work strength analysis
2. Post work energy check

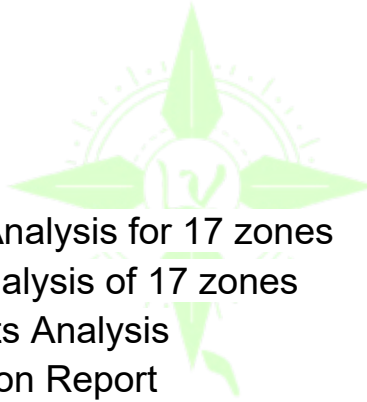



# **MAPS AND DRAWINGS**

लोक विज्ञान

# PROPERTY LAYOUT

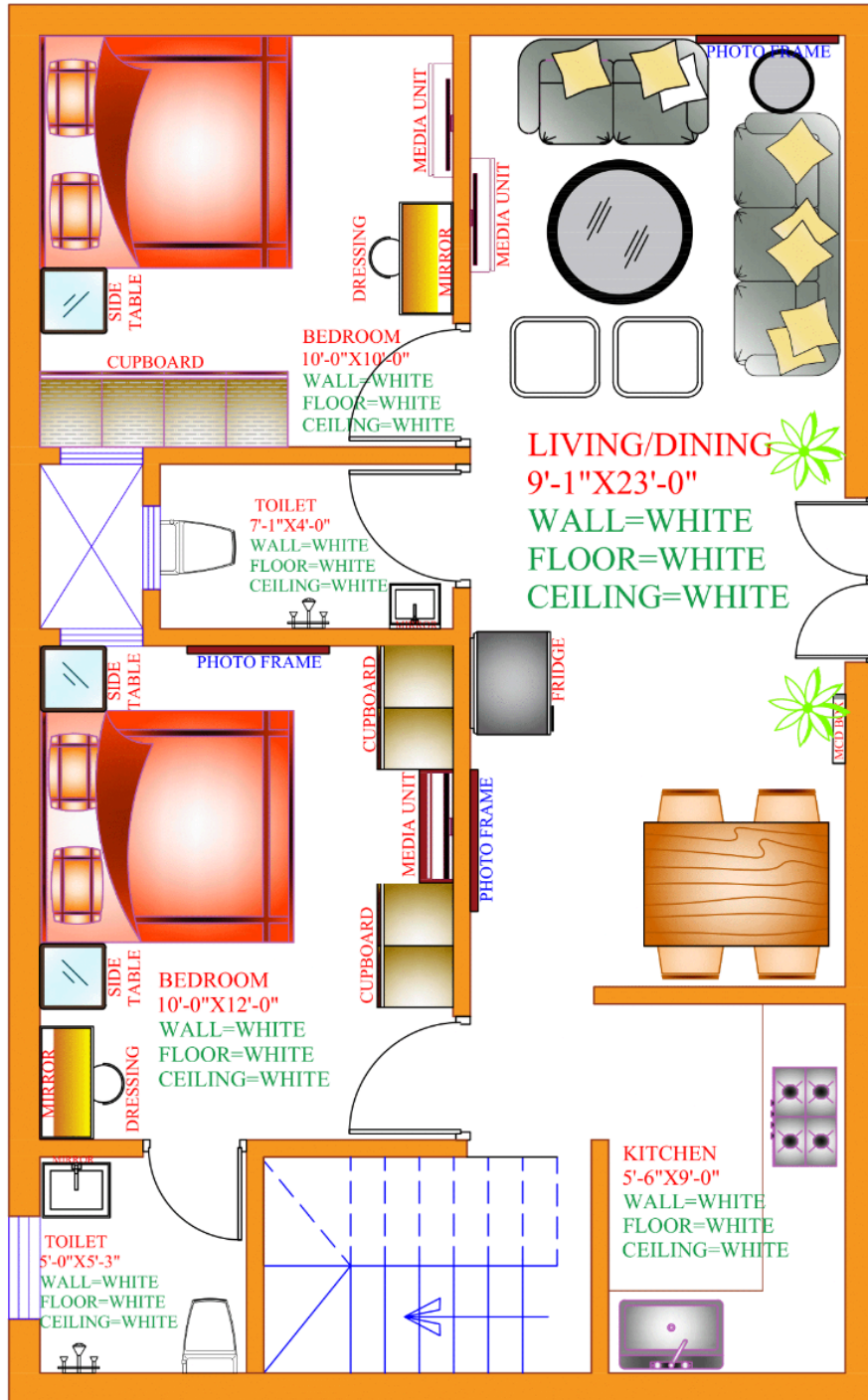

# LAYOUT WITH GRID

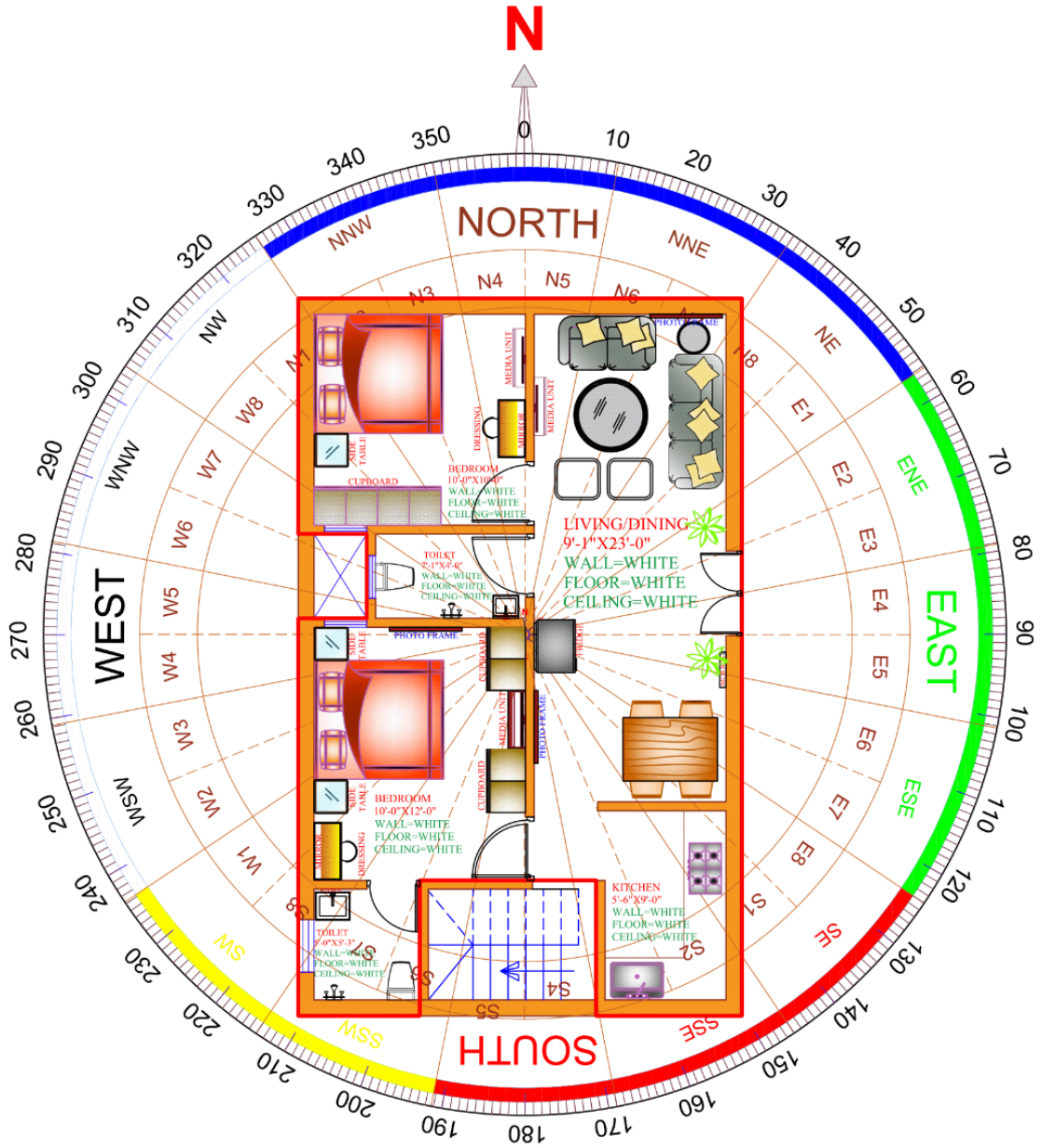

## 16 Direction Bar Chart

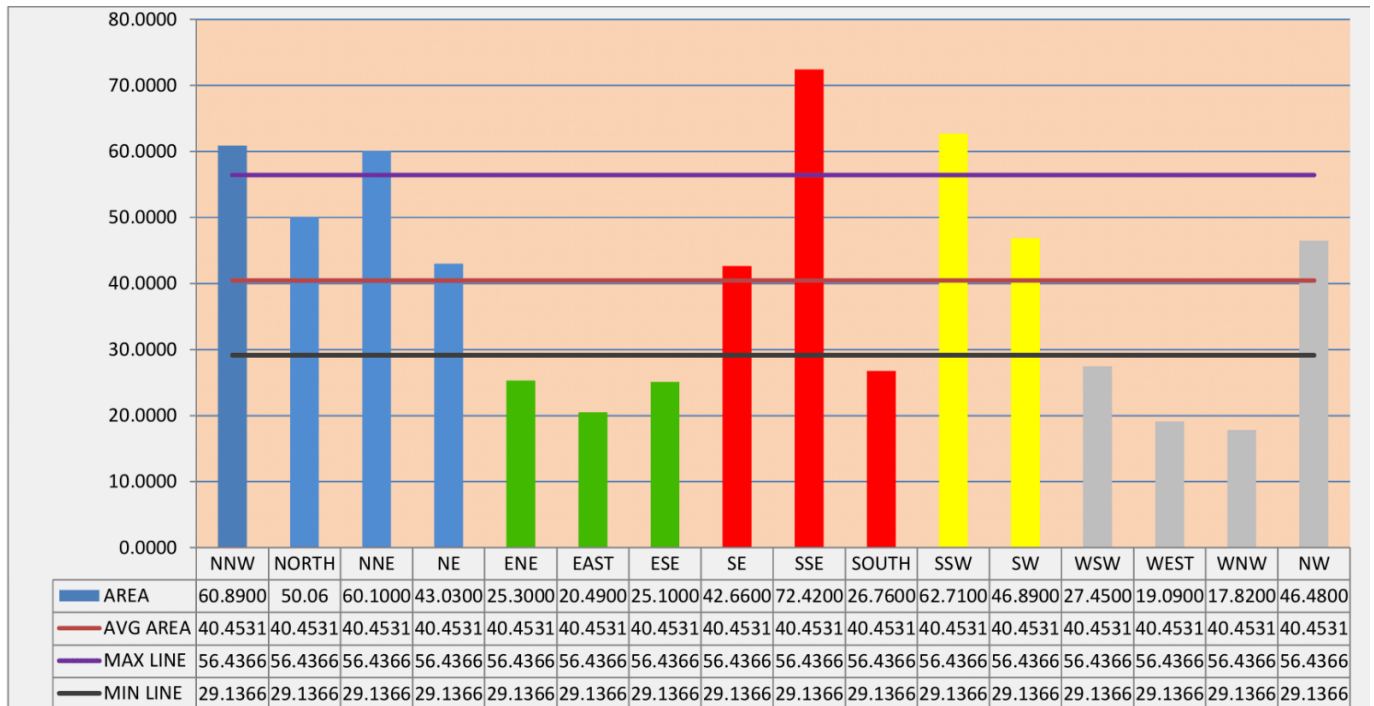

City Vignette

# Mermma Marking

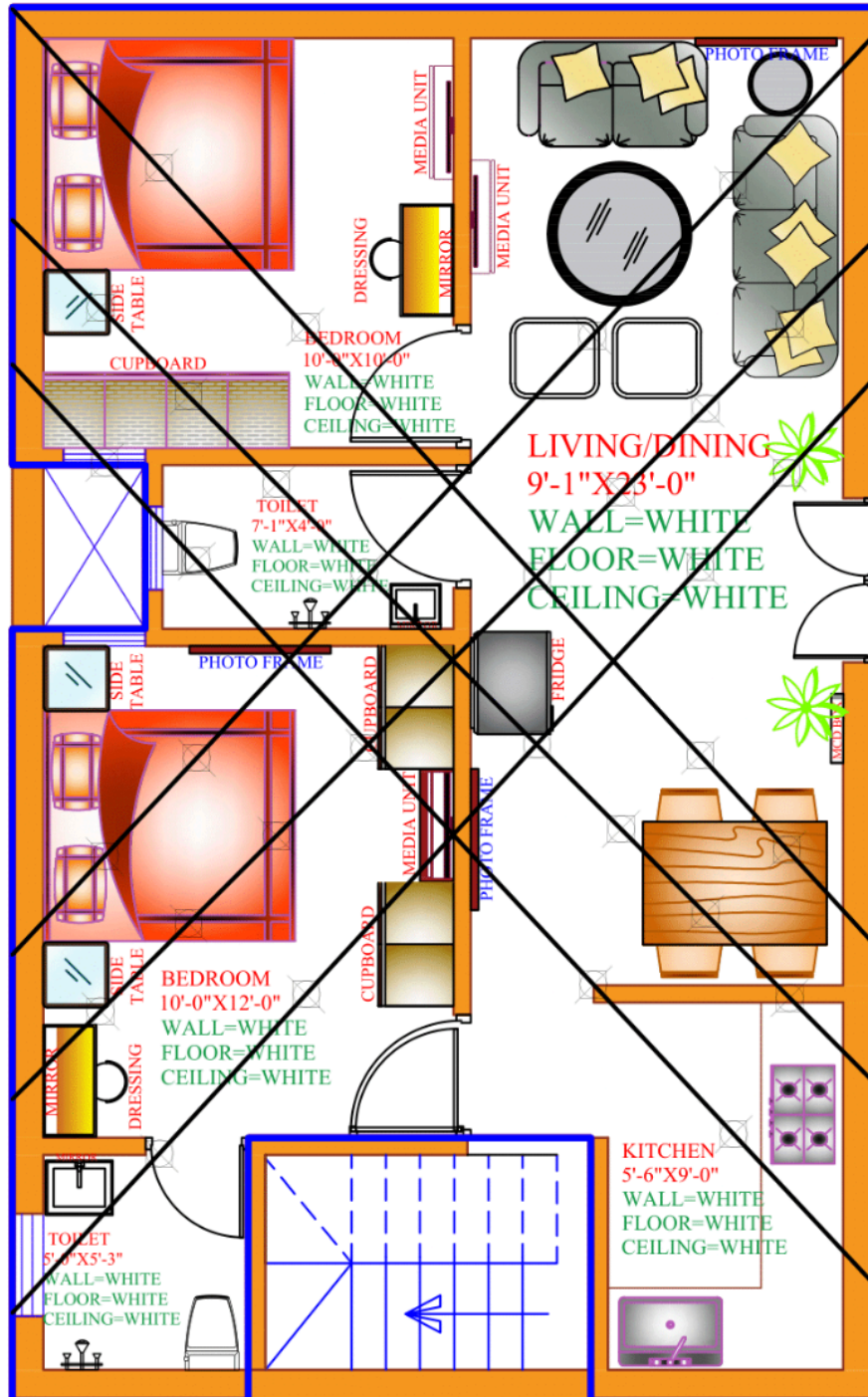

# 1 by 1 Graph

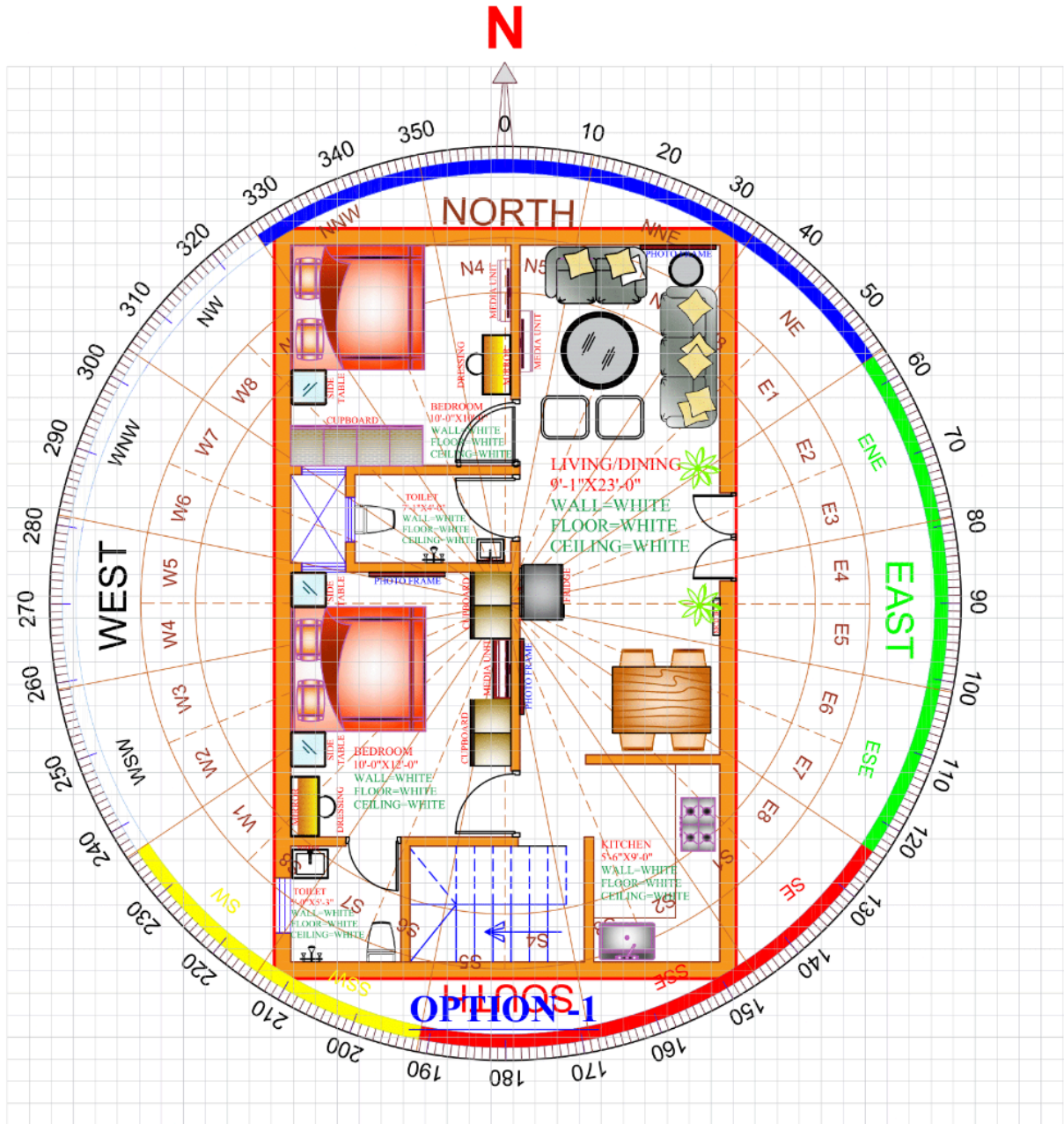



# Zonal Dimensions

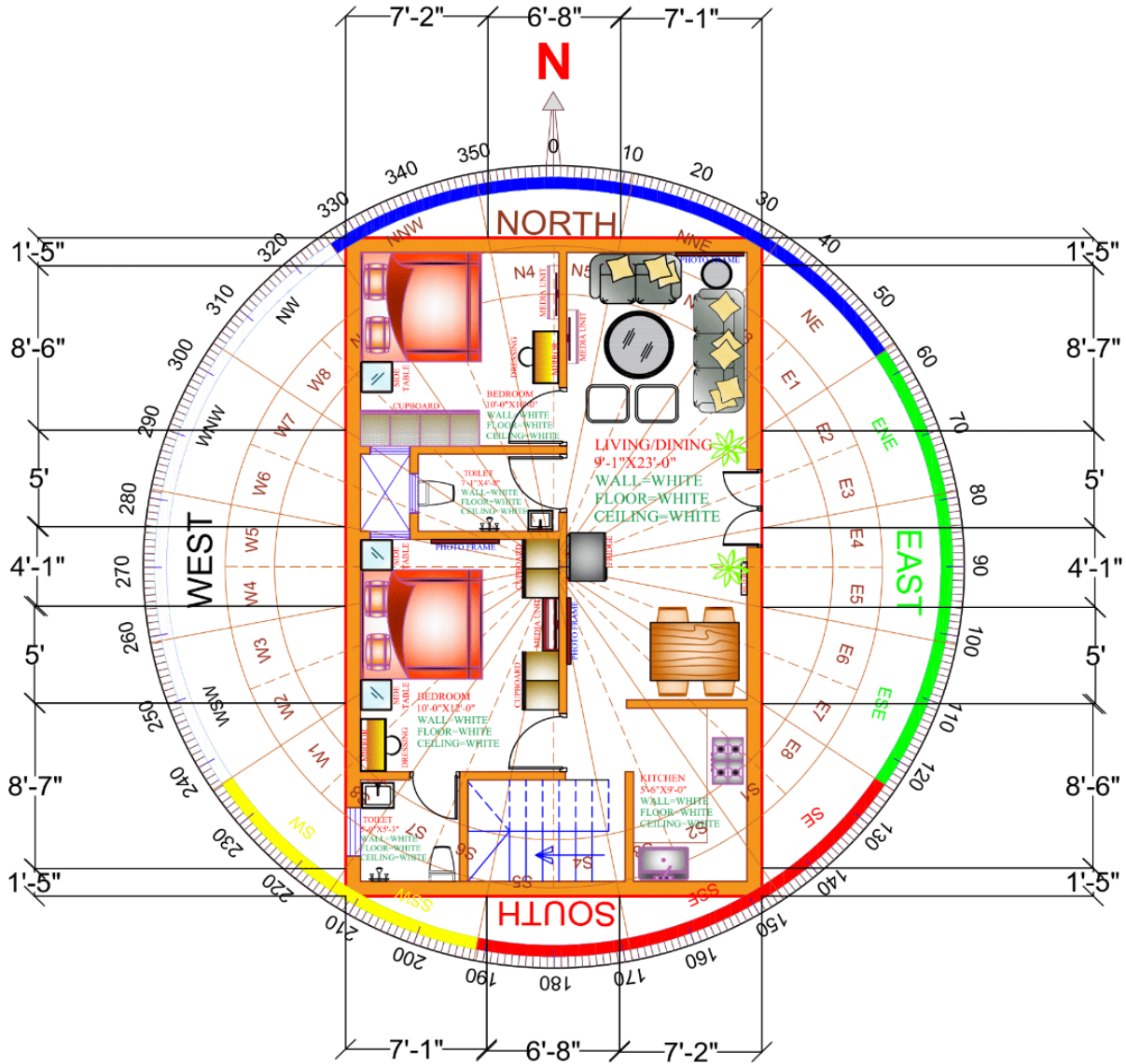

## Element Chart

ELEMENT CHART				
16 ZONES	ELEMENTS	AREA AS PER BARCHART	TOTAL ELEMENTAL STRENGTH	OBSERVATION
EAST		20.4900		
E of SE		25.1000		
SE	FIRE	42.6600	250.14	FIRST ELEMENT
S of SE		72.4200		
SOUTH		26.7600		
S of SW		62.7100		
SW		46.8900		
W of SW		27.4500		
WEST	AIR	19.0900	157.73	THIRD ELEMENT
W of NW		17.8200		
NW		46.4800		
N of NW		60.8900		
NORTH		50.06		
N of NE	WATER	60.1000	239.38	SECOND ELEMENT
NE		43.0300		
E of NE		25.3000		

শ্রীকৃষ্ণ Vigyan

# 45 Devtas Marking

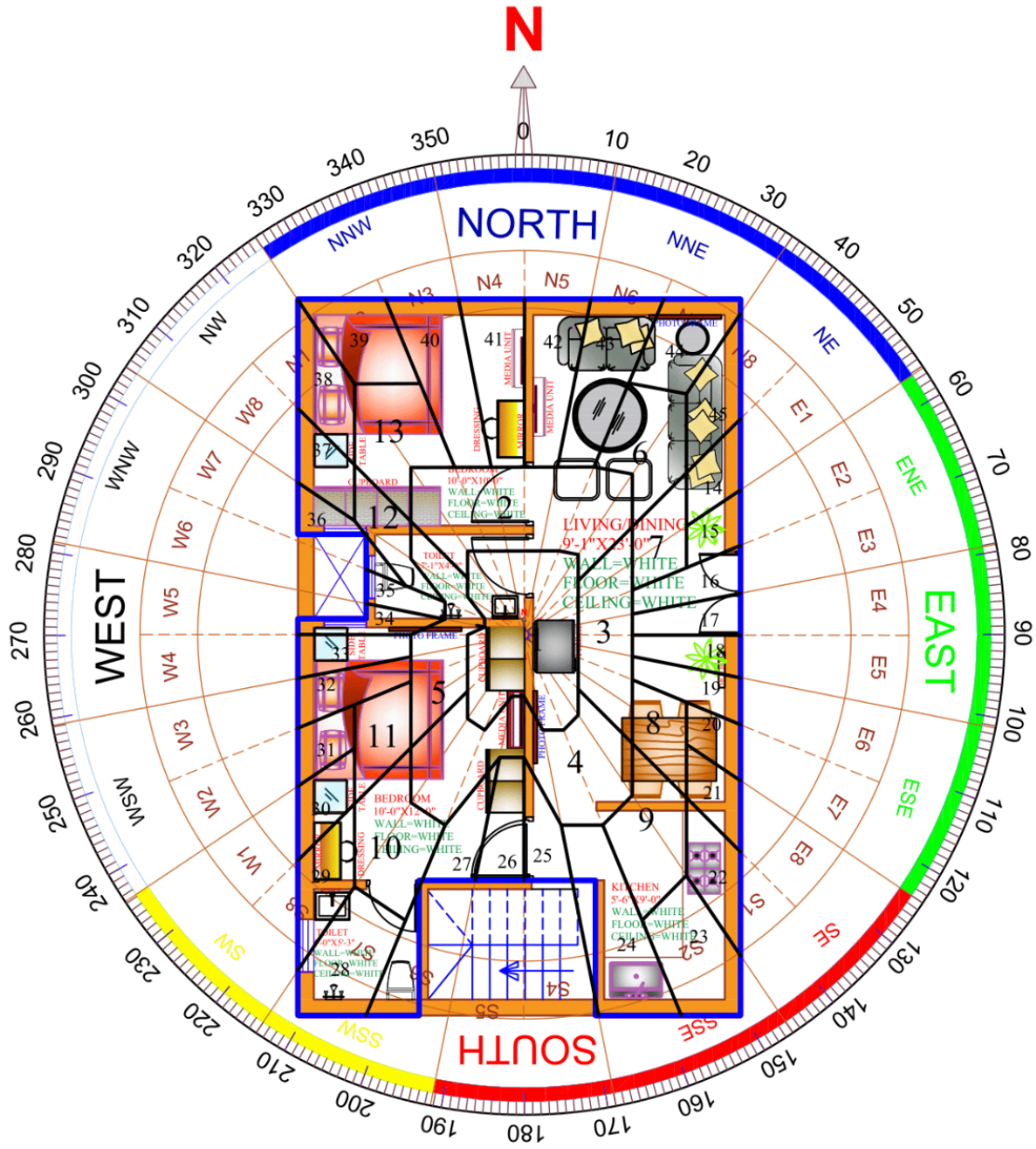

### 45 Devtas Bar Chart

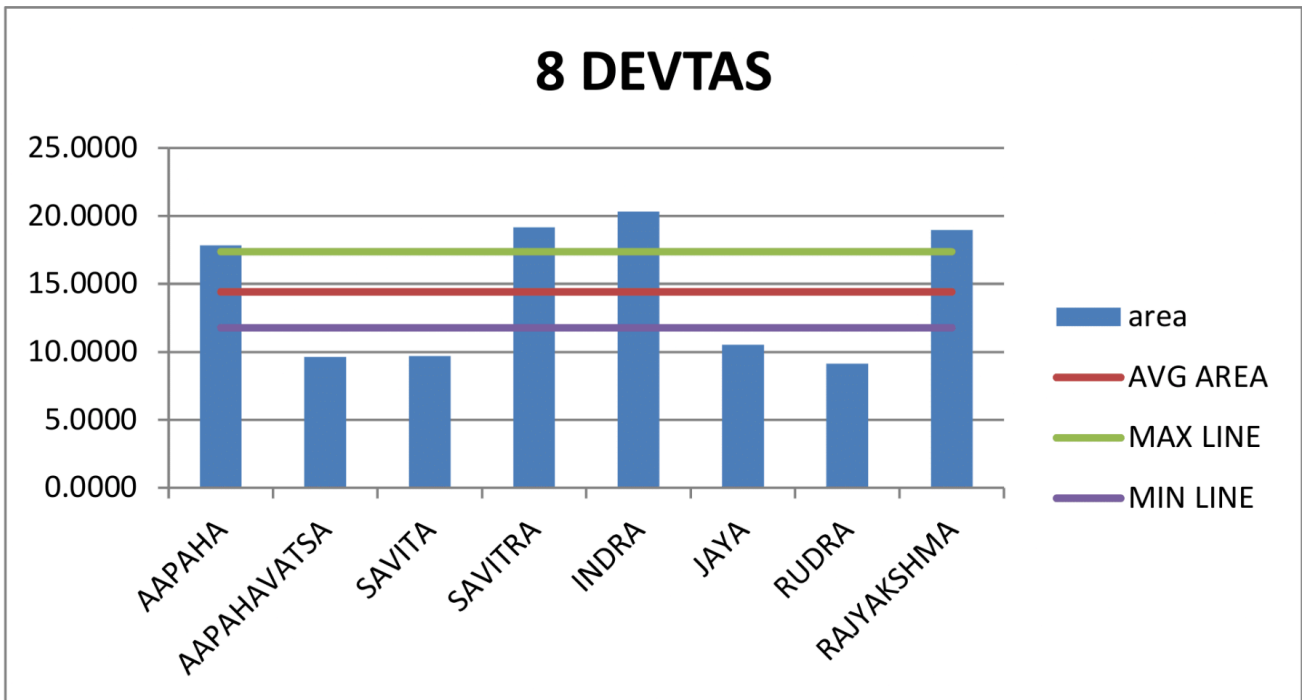
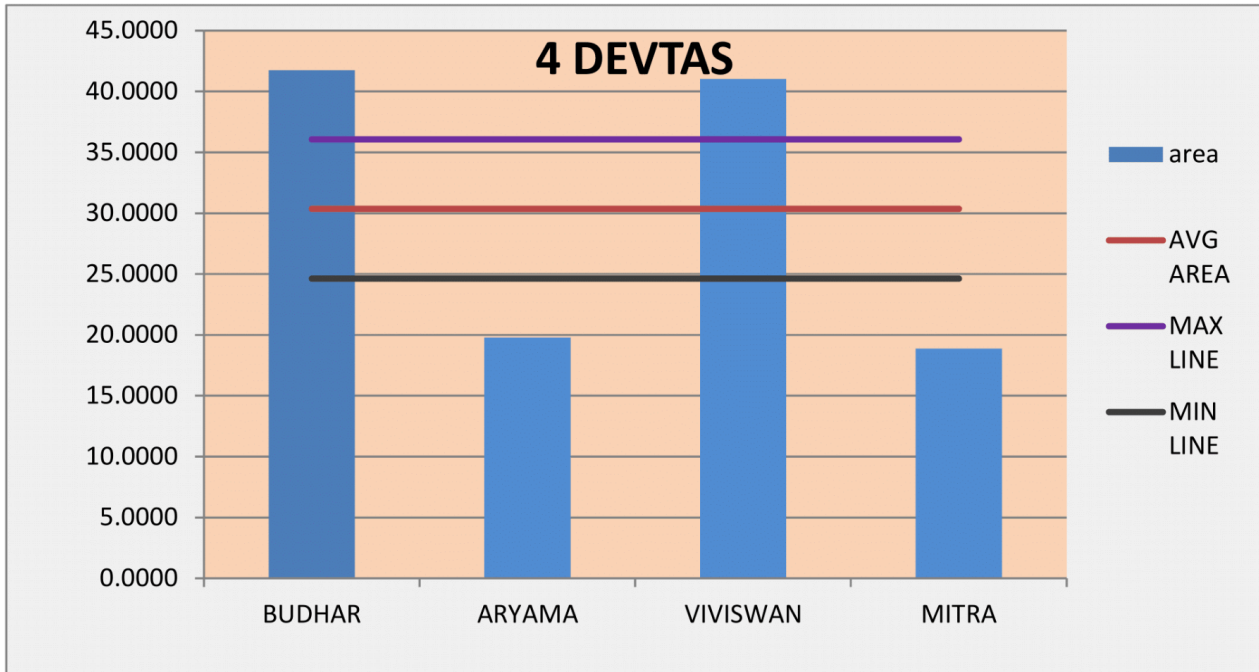

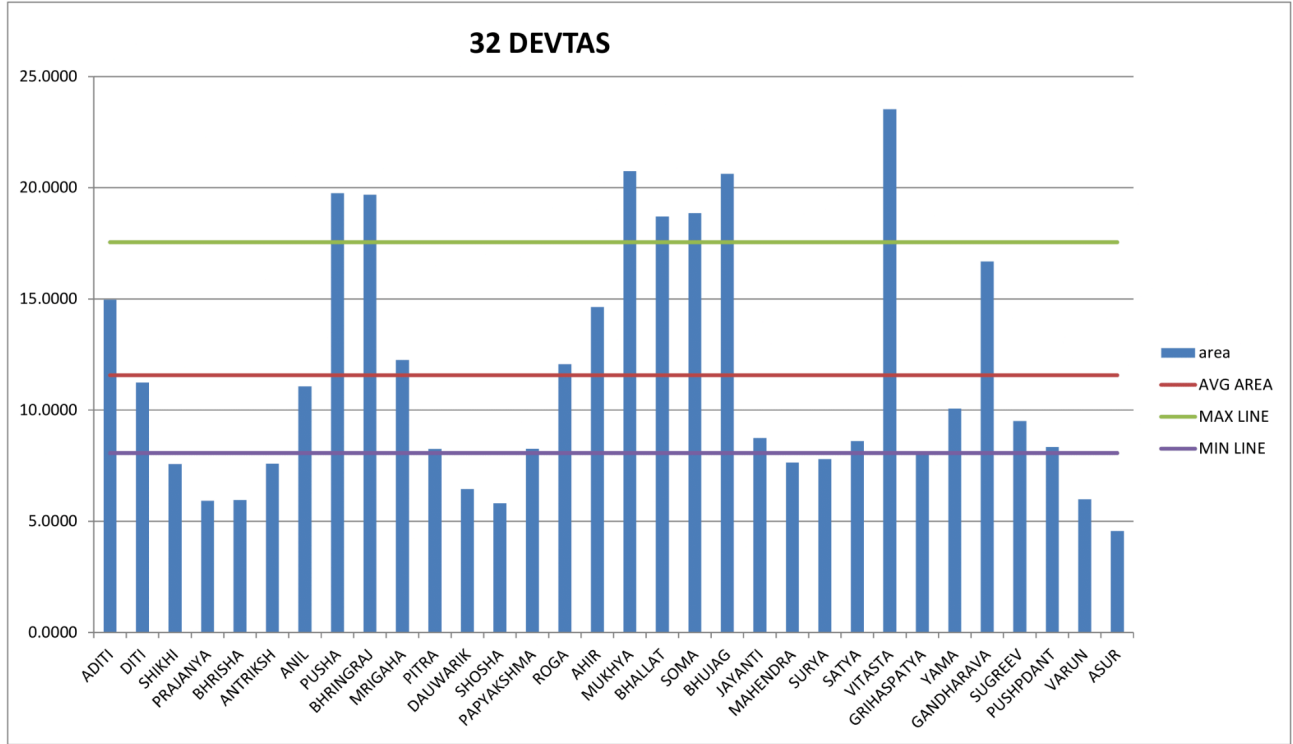

  
 लोक राजपुत्र



## **PRESENT ANALYSIS**

लोक रंगपूजन

## PRE WORK STRENGTH ANALYSIS

### Pre Work Strength Analysis

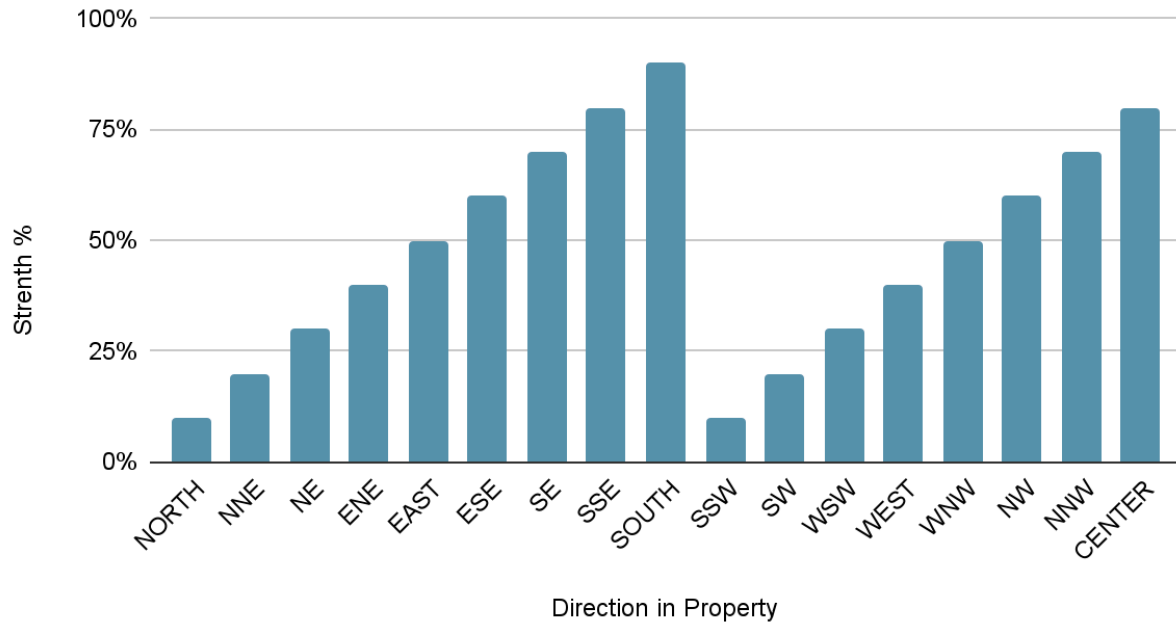

<u>Low Strength Directions</u>	<u>Avg Strength Directions</u>	<u>High Strength Directions</u>
NORTH	ENE	SE
NNE	EAST	SSE
NE	ESE	SOUTH
SSW	WEST	NNW
SW	WNW	CENTER
WSW	NW	

## PRE WORK ENERGY ANALYSIS

### Pre Work Energy Analysis



শ্রীকৃষ্ণ Vigyan

<b><u>Low Energy Directions</u></b>	<b><u>Avg Energy Directions</u></b>	<b><u>High Energy Directions</u></b>
NORTH	ENE	SE
NNE	EAST	SSE
NE	ESE	SOUTH
SSW	WEST	NNW
SW	WNW	CENTER
WSW	NW	



## INCORRECT CONSTRUCTION ANALYSIS

DIRECTION	ELEMENTS LOCATED	PROBLEMS POSSIBILITIES
NORTH		
NNE		
NE		
ENE		
EAST		
ESE		
SE		
SSE		
SOUTH		
SSW		
SW		
WSW		
WEST		
WNW		
NW		
NNW		
CENTER		

## INCORRECT PLACEMENTS ANALYSIS

DIRECTION	ELEMENTS LOCATED	PROBLEMS POSSIBILITIES
NORTH		
NNE		
NE		
ENE		
EAST		
ESE		
SE		
SSE		
SOUTH		
SSW		
SW		
WSW		
WEST		
WNW		
NW		
NNW		
CENTER		



**REMEDIES AND SOLUTIONS**

लोक विज्ञान

# COLOUR THERAPY - PREFERRED COLORS

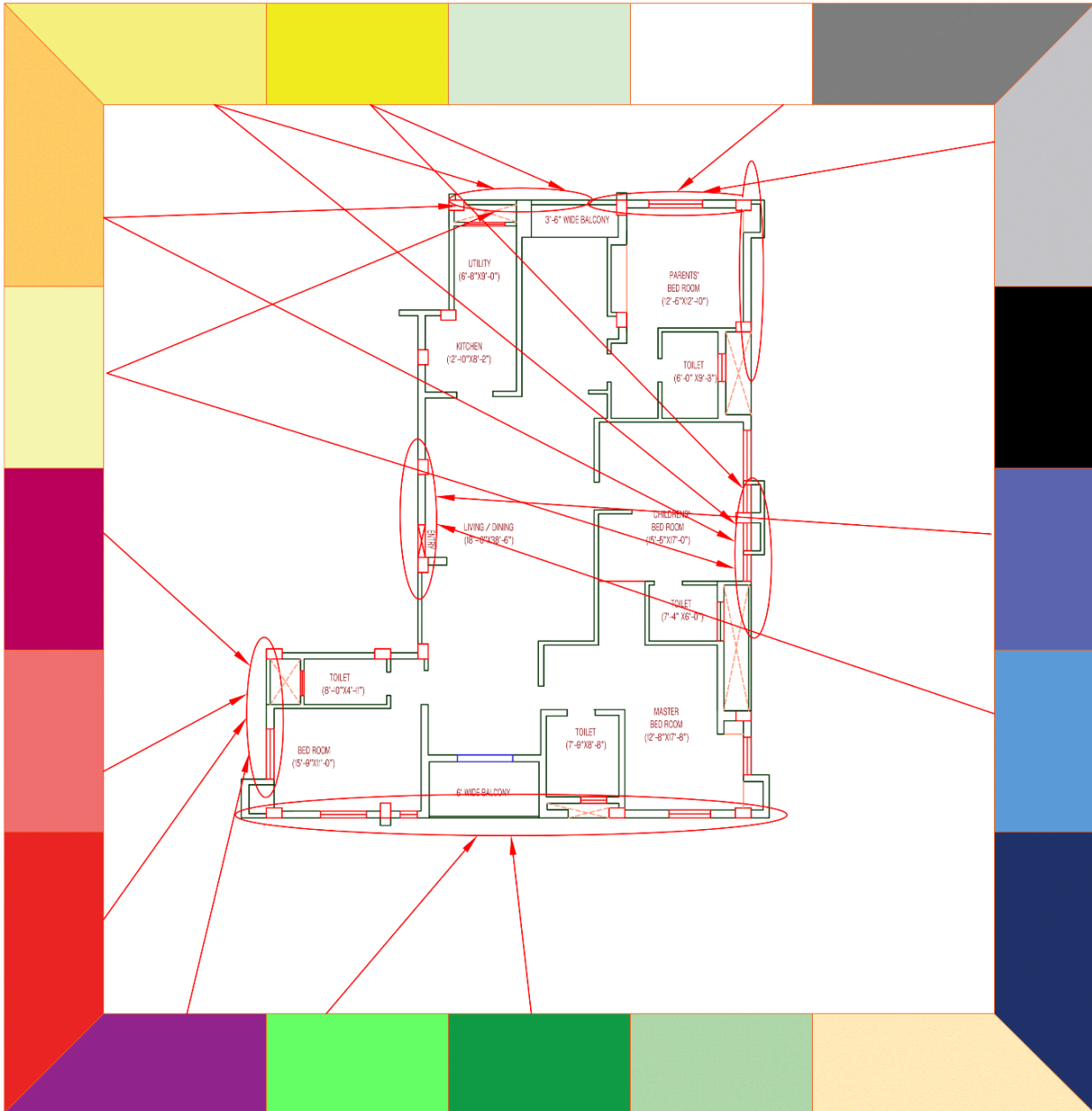

## COLOUR THERAPY - NOT SUITABLE COLORS

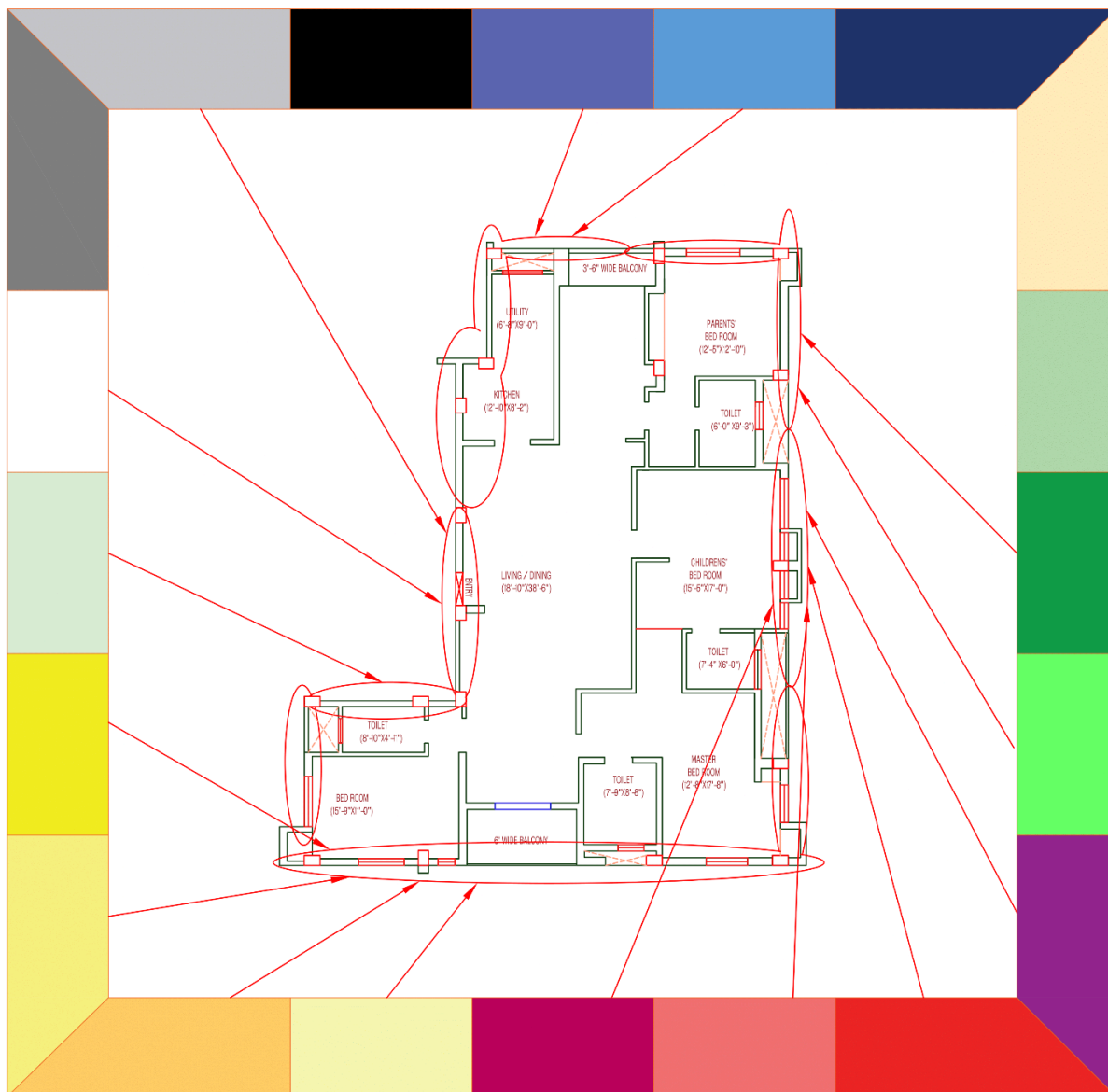

## CORRECT PLACEMENT ANALYSIS

DIRECTION	ISSUES	SOLUTIONS AND REMEDIES
NORTH		
NNE		
NE		
ENE		
EAST		
ESE		
SE		
SSE		
SOUTH		
SSW		
SW		
WSW		
WEST		
WNW		
NW		
NNW		
CENTER		

## CORRECT ENERGY AUDITING

DIRECTION	ISSUES	SOLUTIONS AND REMEDIES
NORTH		
NNE		
NE		
ENE		
EAST		
ESE		
SE		
SSE		
SOUTH		
SSW		
SW		
WSW		
WEST		
WNW		
NW		
NNW		
CENTER		





**POST WORK ANALYSIS**

लोक रांगपुरा



## POST WORK STRENGTH ANALYSIS

Post Work Strength Analysis



DIRECTION	PRE WORK ENERGY	ENERGY INCREASE	POST WORK ENERGIES
NORTH			
NNE			
NE			
ENE			
EAST			
ESE			
SE			
SSE			
SOUTH			
SSW			
SW			
WSW			
WEST			
WNW			
NW			
NNW			
CENTER			

## POST WORK ENERGY ANALYSIS

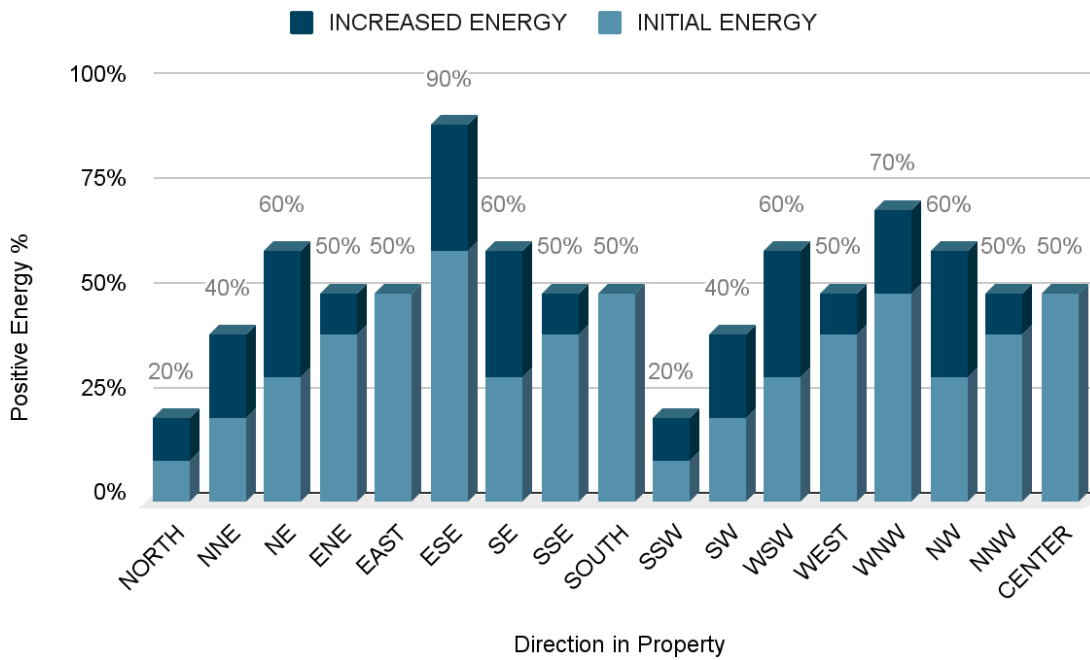

DIRECTION	PRE WORK ENERGY	ENERGY INCREASE	POST WORK ENERGIES
NORTH			
NNE			
NE			
ENE			
EAST			
ESE			
SE			
SSE			
SOUTH			
SSW			
SW			
WSW			
WEST			
WNW			
NW			
NNW			
CENTER			

**Thankyou!!**  
**I hope our work has brought a big success**  
**and removed all your problems**

**This report is made for -**

<Name>

<Company Name>

<Address>

**Report By:**

Dr. Pardieep Jain

Lok Vastu Shastra

Lok Vigyan Samridhi Pvt Ltd

**And do not forget to recommend us to your circle.**

**Lok Vigyan Samridhi Pvt Ltd**

E2-252 First Floor, Main Road, Shastri Nagar, Delhi-110052

CIN: U86900DL2024PTC428613 || PAN: AAFCL7702G

www.lokvastu.com || 91-9990888961 || drpardieepjain@lokvigyan.com